



VALLUVAR NAGAR



PHASE -1 APPROVED LAYOUT LP/DTCP NO : 149/2022

APPROVED PLAN SHOWING THE LAYOUT OF HOUSE SITE IN S.NO : 463/1B,2B,3, 468/1,2A,2B, 469/1,2,3,4,6,7,8 AND 476/2 OF PERUMBAKKAM VILLAGE AND PANCHAYAT, ACHARAPAKKAM PANCHAYAT UNION, MADURANTHAKAM TALUK, CHENGALPATTU DISTRICT.

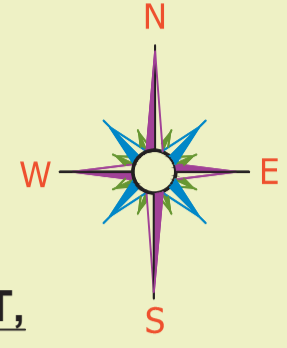

MADURANTHAGAM BDO OFFICE

TO CHENGALPATTU

MADURANTHAGAM BUS STAND
COURT
MADURANTHAGAM TALUK OFFICE

G.S.T ROAD NH-32
TO TINDIVANAM

TO ENDATHUR

EXISTING ENDATHUR TO MADURANTHAKAM ROAD

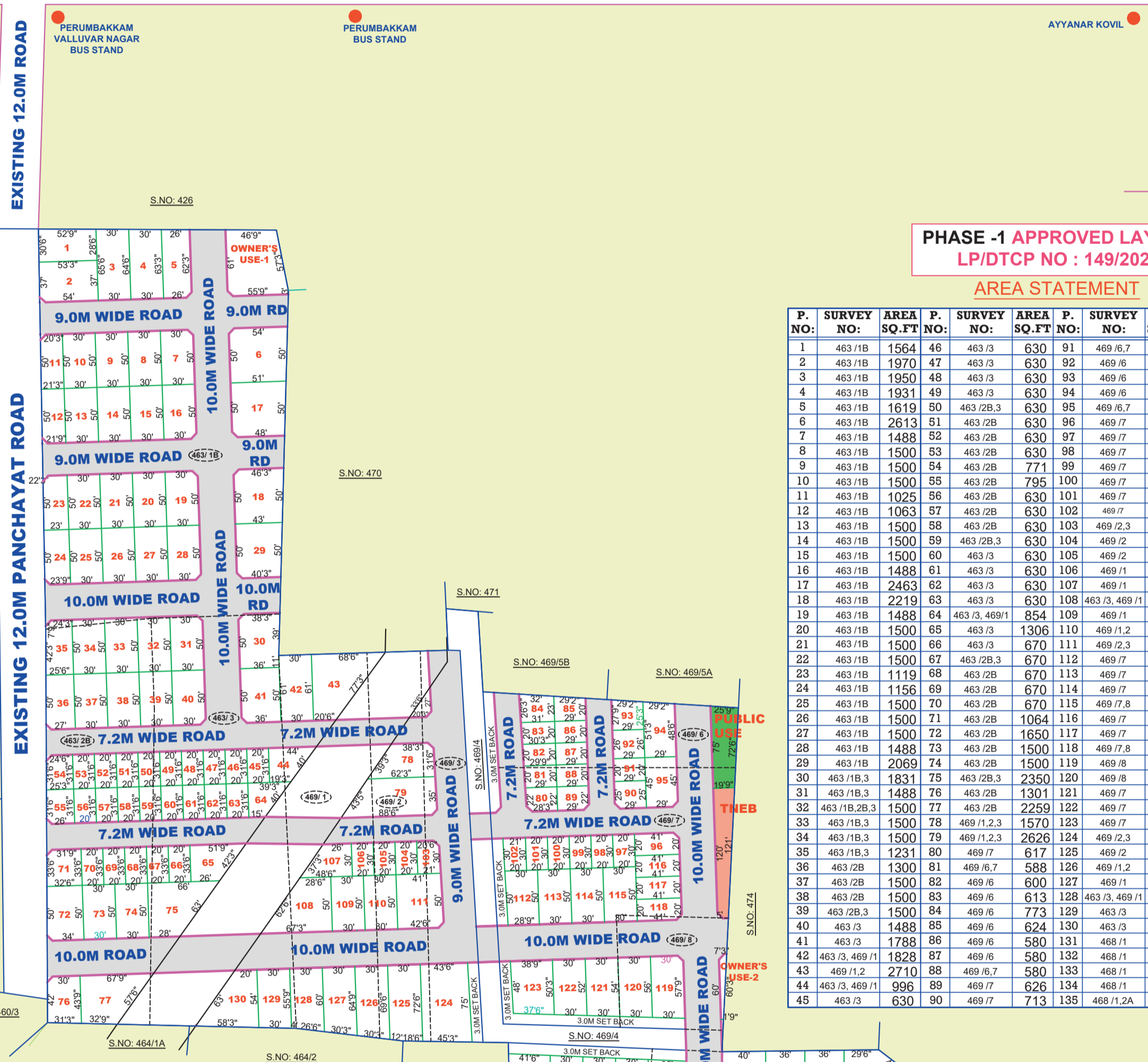

PHASE -1 APPROVED LAYOUT LP/DTCP NO : 149/2022

AREA STATEMENT

P. NO.	SURVEY NO.	AREA SQ.FT	P. NO.	SURVEY NO.	AREA SQ.FT	P. NO.	SURVEY NO.	AREA SQ.FT	P. NO.	SURVEY NO.	AREA SQ.FT
1	463/1B	1564	46	463/3	630	91	469/6,7	580	136	468/2A	1743
2	463/1B	1970	47	463/3	630	92	469/6	754	137	468/2A	1548
3	463/1B	1950	48	463/3	630	93	469/6	769	138	468/2A	1517
4	463/1B	1931	49	463/3	630	94	469/6	1446	139	468/2A	2306
5	463/1B	1619	50	463/2B,3	630	95	469/6,7	1293	140	468/2A	2063
6	463/1B	2613	51	463/2B	630	96	469/7	808	141	468/2A	1650
7	463/1B	1488	52	463/2B	630	97	469/7	600	142	468/2A	1650
8	463/1B	1500	53	463/2B	630	98	469/7	600	143	468/2A	1650
9	463/1B	1500	54	463/2B	771	99	469/7	600	144	468/2A	1650
10	463/1B	1500	55	463/2B	795	100	469/7	600	145	468/2A	1650
11	463/1B	1025	56	463/2B	630	101	469/7	600	146	468/2A	1650
12	463/1B	1063	57	463/2B	630	102	469/7	615	147	468/1,2A	1650
13	463/1B	1500	58	463/2B	630	103	469/2,3	610	148	468/1,2A	1638
14	463/1B	1500	59	463/2B,3	630	104	469/2	600	149	468/1	2076
15	463/1B	1500	60	463/3	630	105	469/2	600	150	468/1	2066
16	463/1B	1488	61	463/3	630	106	469/1	600	151	468/1	1656
17	463/1B	2463	62	463/3	630	107	469/1	1118	152	468/1	1738
18	463/1B	2219	63	463/3	630	108	463/3, 469/1	2394	153	468/1,2A	1638
19	463/1B	1488	64	463/3, 469/1	854	109	469/1	1500	154	468/2A	1650
20	463/1B	1500	65	463/3	1306	110	469/1,2	1500	155	468/2A	1650
21	463/1B	1500	66	463/3	670	111	469/2,3	2075	156	468/2A	1650
22	463/1B	1500	67	463/2B,3	670	112	469/7	1469	157	468/2A	1650
23	463/1B	1119	68	463/2B	670	113	469/7	1500	158	468/2A	1650
24	463/1B	1156	69	463/2B	670	114	469/7	1500	159	468/2A	1650
25	463/1B	1500	70	463/2B	670	115	469/7,8	1500	160	468/2A	1650
26	463/1B	1500	71	463/2B	1064	116	469/7	820	161	468/2A	1588
27	463/1B	1500	72	463/2B	1650	117	469/7	820	162	468/1	1500
28	463/1B	1488	73	463/2B	1500	118	469/7,8	808	163	468/1	1650
29	463/1B	2069	74	463/2B	1500	119	469/8	1694	164	468/1	1650
30	463/1B,3	1831	75	463/2B,3	2350	120	469/8	1650	165	468/1,2A	1662
31	463/1B,3	1488	76	463/2B	1301	121	469/7	1590	166	468/2A	1708
32	463/1B,2B,3	1500	77	463/2B	2259	122	469/7	1534	167	468/2A	1766
33	463/1B,3	1500	78	469/1,2,3	1570	123	469/7	1873	168	468/2A	1433
34	463/1B,3	1500	79	469/1,2,3	2626	124	469/2,3	3269	169	468/2A,2B	582
35	463/1B,3	1231	80	469/7	617	125	469/2	2158	170	468/2A,2B	594
36	463/2B	1300	81	469/6,7	588	126	469/1,2	2014	171	468/2A,2B	594
37	463/2B	1500	82	469/6	600	127	469/1	171	172	468/2B, 476/2	651
38	463/2B	1500	83	469/6	613	128	463/3, 469/1	1731	173	468/2B, 476/2	668
39	463/2B,3	1500	84	469/6	773	129	463/3	1646	174	468/2B, 476/2	540
40	463/3	1488	85	469/6	624	130	463/3	2071	175	468/2B, 476/2	540
41	463/3	1788	86	469/6	580	131	468/1	1646	176	468/2B	588
42	463/3, 469/1	1828	87	469/6	580	132	468/1	1144	177	468/2B, 476/2	2852
43	469/1,2	2710	88	469/6,7	580	133	468/1	1121	178	468/1	3083
44	463/3, 469/1	996	89	469/7	626	134	468/1	1099	179	469/8	258
45	463/3	630	90	469/7	713	135	468/1,2A	1239			

PHASE -2 APPROVED LAYOUT LP/DTCP NO : 78/2014

S.NO: 465/1

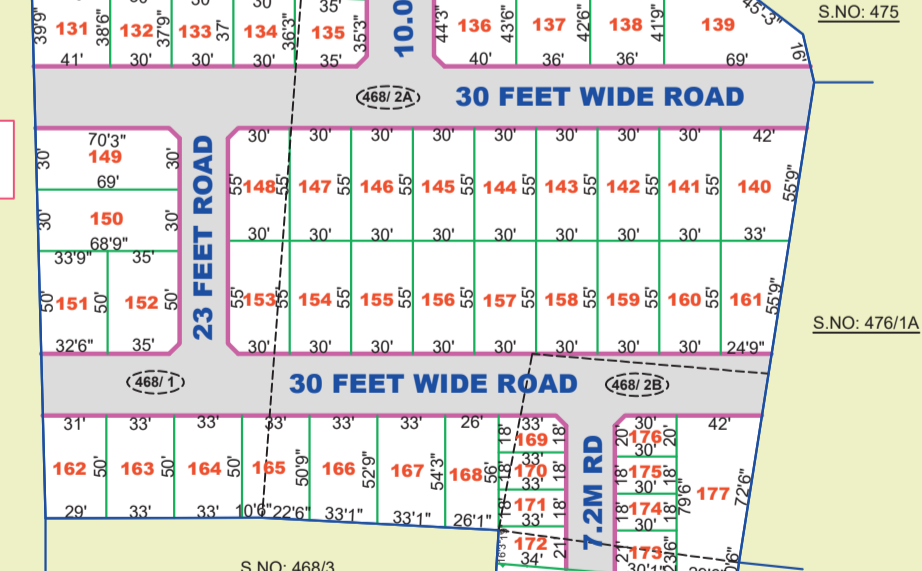

PHASE -2 APPROVED LAYOUT LP/DTCP NO : 78/2014

S.NO: 468/3

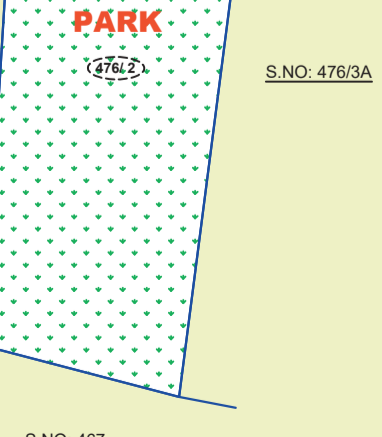

S.NO: 467

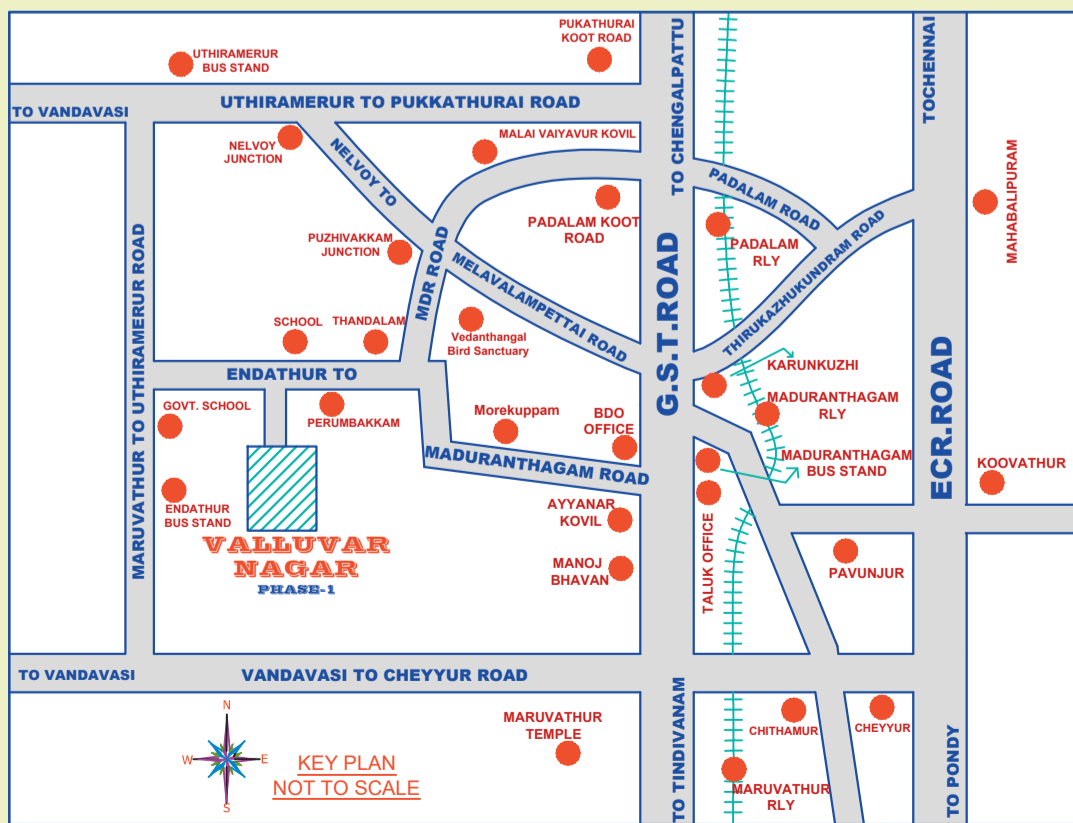

KEY PLAN
NOT TO SCALE



VALLUVAR NAGAR

PHASE -2 APPROVED LAYOUT
LP/DTCP NO : 78/2014

APPROVED PLAN SHOWING THE LAYOUT OF HOUSE SITE IN S.NO : 458/2, 460/3, 464/1A,1B,2,3, 465/1,2A,2B,3 AND 468/3 OF PERUMBAKKAM VILLAGE AND PANCHAYAT, ACHARAPAKKAM PANCHAYAT UNION, MADURANTHAKAM TALUK, CHENGALPATTU DISTRICT.

MADURANTHAGAM BDO OFFICE



TO CHENGALPATTU

- MADURANTHAGAM BUS STAND
- COURT
- MADURANTHAGAM
- TALUK OFFICE

TO ENDATHUR

EXISTING ENDATHUR TO MADURANTHAKAM ROAD

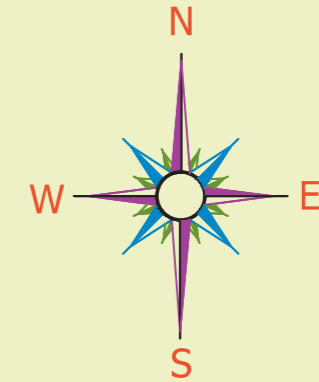
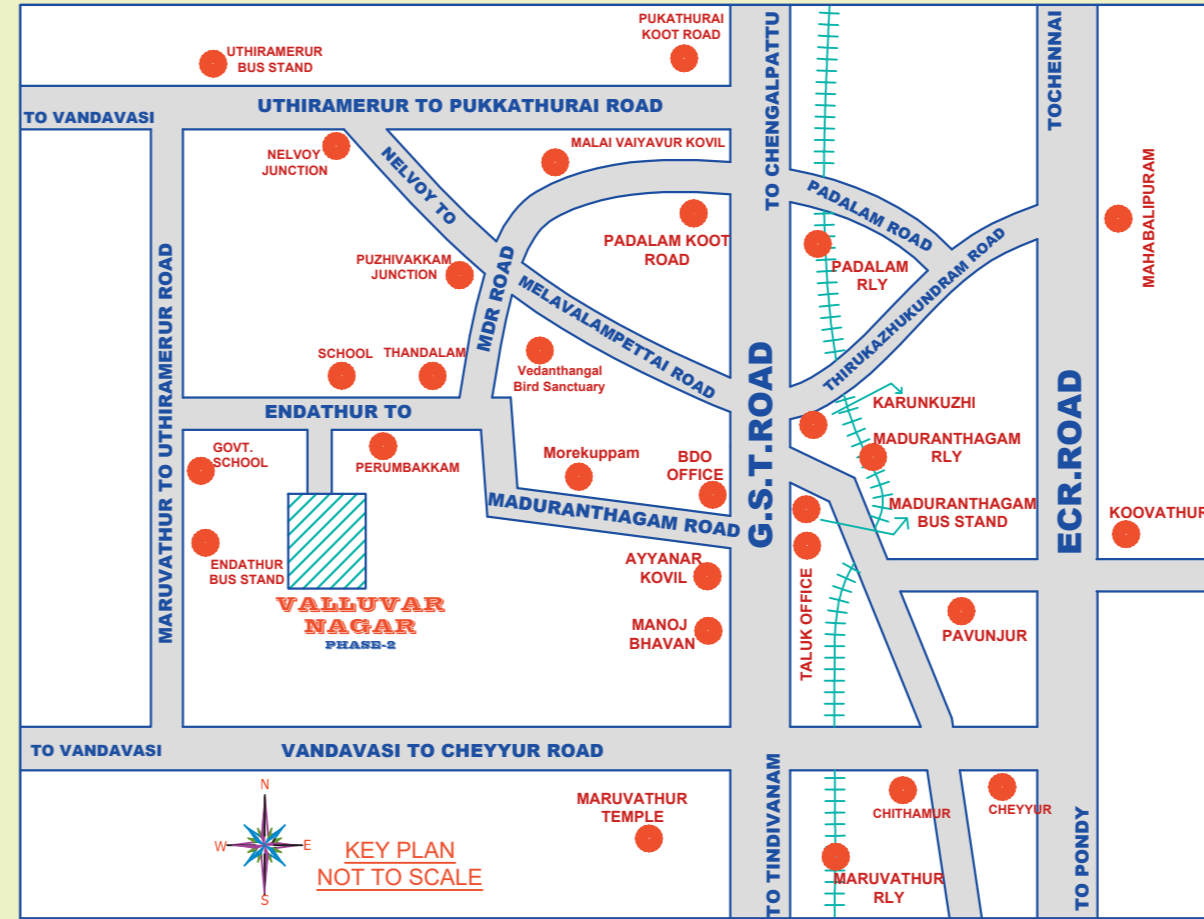

PHASE -2 APPROVED LAYOUT
LP/DTCP NO : 78/2014

AREA STATEMENT

P. NO.	SURVEY NO.	AREA SQ.FT	P. NO.	SURVEY NO.	AREA SQ.FT	P. NO.	SURVEY NO.	AREA SQ.FT	P. NO.	SURVEY NO.	AREA SQ.FT
1	460/3	4563	46	464/1A,1B,2	1650	91	465/2B	1908	136	465/3	600
2	460/3	2599	47	464/2	1650	92	465/2B	1800	137	465/3	600
3	460/3, 464/1A	2606	48	464/2	1650	93	465/2B	1800	138	465/3	600
4	460/3, 464/1A	2618	49	464/2	1650	94	465/2B	1800	139	464/3, 465/3	600
5	460/3, 464/1A	2406	50	464/2	1650	95	465/2B	1800	140	464/3	600
6	458/2, 464/1B	818	51	464/2	1650	96	465/2B	1788	141	464/3	648
7	458/2	1459	52	464/2	1650	97	465/2B	588	142	458/2 & 464/3	1908
8	458/2	1815	53	464/2, 465/1	1650	98	465/2B	600	143	458/2, 464/3	1800
9	458/2	1890	54	465/1	1650	99	465/2B	600	144	458/2, 464/3	1800
10	458/2	1950	55	465/1	1650	100	465/2B	600	145	458/2, 464/3	1800
11	458/2	1991	56	465/1	1760	101	465/2B	600	146	458/2, 464/3	1800
12	458/2	2033	57	465/1, 2B	1463	102	465/2B	600	147	458/2, 464/3	1788
13	458/2	2081	58	465/1, 2B	1500	103	465/2B	600	148	458/2	2164
14	458/2	3052	59	465/1, 2B	1500	104	465/2B	600	149	458/2	2040
15	458/2	4093	60	464/2, 465/1, 2B	1500	105	465/2B	600	150	458/2	2040
16	464/1A	1578	61	464/2, 465/2B	1500	106	465/2A, 2B	648	151	458/2	2040
17	464/1A	1020	62	464/2	1500	107	465/2A, 2B	600	152	458/2	2040
18	464/1A	143	63	464/2	1500	108	465/2A, 2B	600	153	458/2	2028
19	464/1A	605	64	464/2	1500	109	465/2A, 2B	600	154	458/2	1734
20	464/1A, 2	2079	65	464/2	1500	110	465/2A, 2B	600	155	458/2	1636
21	464/2	1924	66	464/2	1500	111	465/2A, 2B	600	156	458/2	1316
22	464/2	1901	67	464/1B, 2	1500	112	465/2A, 2B	600	157	465/3	1886
23	464/2	1880	68	464/1B	1500	113	465/2A, 2B	600	158	465/3	1800
24	464/2	1770	69	464/1B	2438	114	465/2A, 2B	588	159	465/3	1588
25	464/2	1665	70	458/2, 464/1B	2660	115	465/2A	588	160	465/3	1500
26	464/2, 465/1	1587	71	458/2	2438	116	465/2A	600	161	465/3	6661
27	465/1	1523	72	458/2, 464/1B	1740	117	465/2A	600	162	465/2A	2280
28	465/1	1508	73	458/2, 464/1B, 3	1740	118	465/2A	600	163	465/2A, 2B	2223
29	465/1	1418	74	464/2, 3	1740	119	465/2A	600	164	465/2B	2170
30	465/1	1678	75	464/2, 3	1740	120	465/2A	600	165	465/2B	2118
31	465/1	1650	76	464/2, 3, 465/2A	1740	121	465/2A	600	166	465/2B	2222
32	465/1	1650	77	464/2, 465/2A	1740	122	465/2A	600	167	465/2A	606
33	464/2, 465/1	1650	78	464/2, 465/2A	1740	123	465/2A	648	168	465/2A	600
34	464/2	1650	79	464/2, 465/2A, 2B	1740	124	464/3	648	169	465/2A, 2B	600
35	464/2	1650	80	465/2B	1740	125	464/3	600	170	465/2B	600
36	464/2	1650	81	465/2B	1740	126	464/3, 465/3	600	171	465/2B	600
37	464/2	1650	82	465/2B	1740	127	465/3	600	172	465/2B	600
38	464/2	1650	83	465/2B	1740	128	465/3	600	173	465/2B	600
39	464/2	1650	84	465/2B, 468/3	1740	129	465/3	600	174	465/2B	600
40	464/1A, 2	1925	85	468/3	1918	130	465/3	600	175	465/2B	600
41	464/1A	1586	86	468/3	1922	131	465/3	600	SHOP-1	464/1A, 1B	1365
42	464/1A	252	87	468/3	1737	132	465/3	588	SHOP-2	464/1B	194
43	464/1A, 1B	1103	88	468/3	1695	133	465/3	588			
44	464/1B	1908	89	468/3	1646	134	465/3	600			
45	464/1A, 1B	1650	90	468/3	1752	135	465/3	600			

G.S.T ROAD NH-32

TO TINDIVANAM